

BUILT FOR WORK



SEWAGE AND WASTEWATER PUMPS

Electric Submersible Pumps • Accessories



Simple Design, Extreme Quality.

Cable Entry

Every power cable has an anti-wicking block at the cable entrance of our submersible motors. This design requires that each conductor is stripped back and the exposed wire is sealed by molded rubber or an epoxy potting, which acts as a permanent water block, for each conductor.



Motor

The submersible dry-type squirrel cage continuous duty rated induction motor, housed in a watertight casing, comes available in insulation classes B, E, F or H. With normal recommended operating temperatures of 104 F. However higher temperature ratings are available upon request.

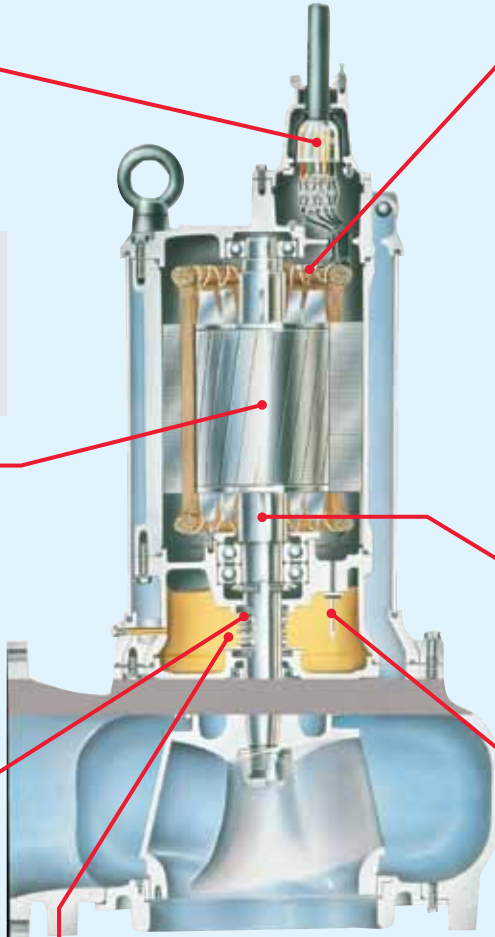

Motor Protector

Use of a Circle Thermal Protector (CTP) in small pumps is an advantage in applications where a control panel is not likely provided. Integrated in the motor housing, the CTP directly cuts the motor circuit if excessive heat builds up or an overcurrent caused by an electrical or mechanical failure.



A Miniature Thermal Protector (MTP) is embedded in each winding of the motor. Should the winding temperature rise to the actuating temperature, the bimetal strip opens to cause the control panel to shut the power supply.



MTPs are supplied as standard on all pumps 15HP and larger.

Shaft

The high-tensile stainless steel shaft used on all pumps is designed to have adequate strength for the transmission of the full load. It is supported by ball type, high-quality, deep-groove bearings.

Mechanical Seal

The mechanical seal with two seal faces containing silicon carbide (SiC) is equipped with the oil chamber. The advantages of the seal are two-fold, it eliminates spring failure caused by corrosion, abrasion or fouling which prevents the seal faces from closing properly, and prevents loss of cooling to the bottom seal faces during run-dry conditions which can cause the bottom seal to fail.



Oil Lifter

The Oil Lifter was developed as a lubricating device for the mechanical seal. Utilizing the centrifugal force of the shaft seal, the Oil Lifter forcibly supplies lubricating oil to the mechanical seal and continues to supply the oil to the upper seal faces even if lubricant falls below the rated volume.

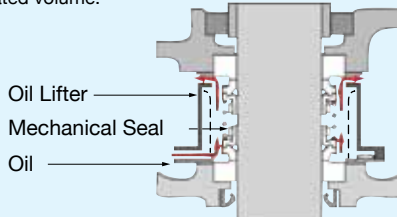

Oil Lifter
Mechanical Seal
Oil

Moisture Sensor

A stainless steel electrode sensor is standard for all pumps 30HP and larger. An optional external sensor is available for all smaller HP pumps. These sensors detect the intrusion of water into the seal chamber area of the pump and can be wired to customers control panel, to alert operators, of this condition.



Guide-Rail Fitting System

The guide rail fitting system connects the pump to and from the piping easily just by lowering and hoisting the pump, allowing easy maintenance and inspection without the need to enter the sump.

Pump models used in combination with the guide rail fitting system can be identified by the prefix "TO or TOS" and "TOK". Refer to standard specifications for availability and model numbers.

TOS and TO

The TOS/TO is the standard guide rail fitting system made of cast-iron and is compatible with cast-iron pumps. Pumps having a discharge bore from 2 inches to 6 inches are available for the TOS, and from 8 inches to 32 inches are available for the TO.



TOK

The TOK guiderail connecting system is made of a high-quality corrosion resistant resin. This system is specifically designed for use with the corrosion resistant light weight VANCS series pumps. Making everything in the sump corrosion resistant guaranteeing a long trouble free life of your pump system.



B Series



The **B SERIES** Tsurumi submersible pump is designed for handling raw sewage, wastewater and heavy duty industrial applications, where the pump is subject to complete submersion and requires maximum reliability. The **B SERIES** has a proven track record for offering long life in both continuous and intermittent sump applications. With multiple impeller designs available in the **B SERIES**, Tsurumi has the right model to handle every application to efficiently transfer the most aggressive liquids. Available up to 20HP in Free-standing, Guide Rail & Dry Pit designs.

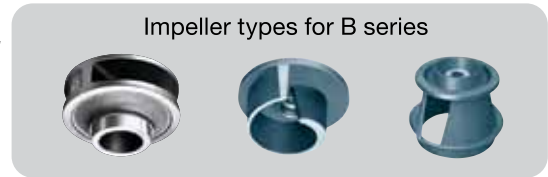

Performance Curves

Discharge Size: 2"- 3"

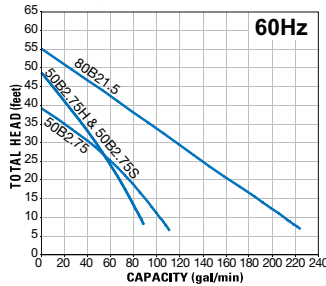

Discharge Size: 4"

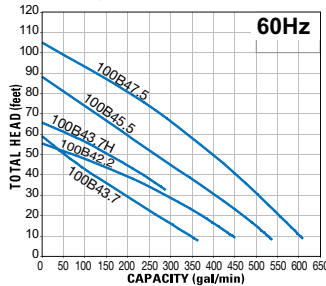

Discharge Size: 6"

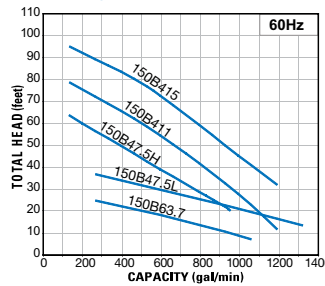

Discharge Size: 8"

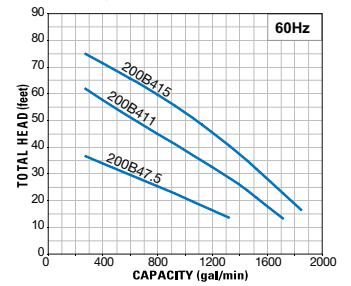

Specifications

Model	Discharge Size (inch)	Phase	Motor Output (HP)	Voltages (V)	Dimensions (inch)						Cable Length (ft)	Free Standing Weight (lbs.)	* Guide Rail Fitting Weight (lbs.)
					Free Standing Models			TOS or TO Guide Rail Models					
					A	B	C	D	E	F			
50B2.75S	2	1Ø	1	115-120/230	15 15/16	9 13/16	20 9/16	24 7/16	9 13/16	22 5/16	32	70	66
50B2.75H	2	3Ø	1	208-230/460/575	15 15/16	9 13/16	16 5/16	24 7/16	9 13/16	18 1/16	32	53	51
50B2.75	2	3Ø	1	208-230/460/575	15 15/16	9 13/16	17 5/16	24 7/16	9 13/16	18 7/8	32	55	53
80B2.1.5	3	3Ø	2	208-230/460/575	17 9/16	9 13/16	21 1/8	26 5/16	9 13/16	23 1/16	32	79	75
100B42.2	4	3Ø	3	208-230/460/575	23 7/16	13 1/16	24 1/4	29 11/16	13 1/16	24 13/16	32	154	141
100B43.7H	4	3Ø	5	208-230/460/575	23 7/16	13 1/16	26 1/4	29 11/16	13 1/16	26 13/16	32	183	170
100B43.7	4	3Ø	5	208-230/460/575	23 11/16	13 3/8	27 3/16	29 15/16	13 3/8	27 9/16	32	190	176
100B45.5	4	3Ø	7.5	208-230/460/575	27	16 1/8	35 3/4	35 5/8	15 1/8	35 11/16	32	324	309
100B47.5	4	3Ø	10	208-230/460/575	27	16 1/8	36 9/16	35 5/8	15 1/8	36 1/2	32	371	356
150B47.5H	6	3Ø	10	208-230/460/575	32 13/16	16 7/16	37 1/2	28 11/16	15 7/8	38 7/16	32	460	400
150B47.5L	6	3Ø	10	208-230/460/575	34 5/16	19 1/8	42 11/16	41 15/16	18 1/16	40 9/16	32	440	380
150B411	6	3Ø	15	208-230/460/575	35 1/4	19 5/16	43 1/4	42 7/8	18 1/4	41 7/16	32	550	490
150B415	6	3Ø	20	208-230/460/575	35 1/4	19 5/16	46	42 7/8	18 1/4	44 3/16	32	600	530
150B63.7	6	3Ø	5	208-230/460/575	33	16 11/16	35 9/16	40 1/4	15 9/16	36 7/16	32	620	550
200B47.5	8	3Ø	10	208-230/460/575	36 7/16	19 1/8	42 11/16	49 13/16	18 1/16	41 5/16	32	460	470
200B411	8	3Ø	15	208-230/460/575	36 7/16	19 1/8	44 1/2	49 13/16	18 1/16	43 1/8	32	570	580
200B415	8	3Ø	20	208-230/460/575	38 1/4	20 11/16	47 1/16	48 9/16	17 1/16	45 11/16	32	660	630

* Pump Weight Only

Dimension: Free Standing

Dimension: Guide Rail Fitting (TO / TOS)

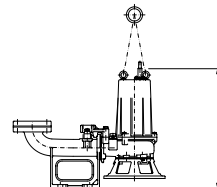
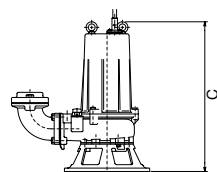
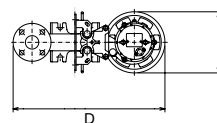
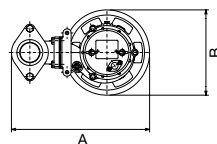

BK Series



The **BK Series** features with a standard built in internal cooling jacket design. The **BK SERIES** offers continued cooling when low sump levels may be present. Tsurumi has the right model to handle every application to efficiently transfer the most aggressive liquids. Available from 30-60HP in Free-standing, and Guide Rail designs.

Performance Curves

Discharge Size: 6" - 8"

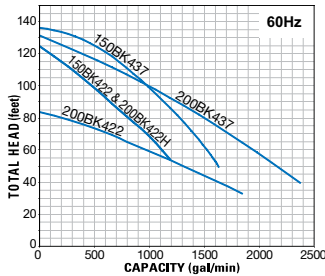

Discharge Size: 10"

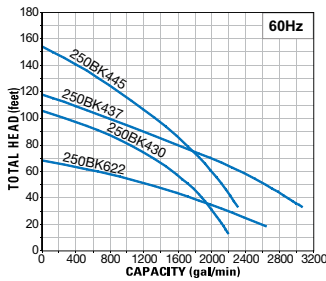

Discharge Size: 12"

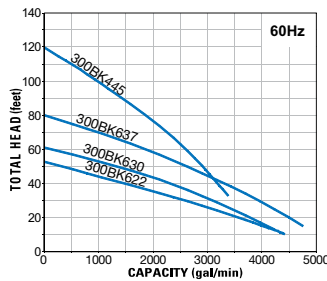

Discharge Size: 14" - 16"

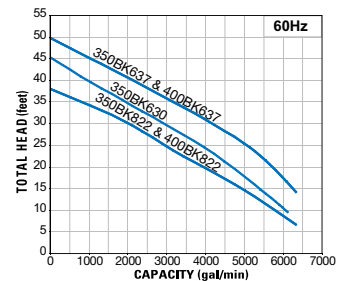

Specifications

Model	Discharge Size (inch)	Phase	Motor Output (HP)	Voltages	Dimensions (inch)						Cable Length (ft)	Free Standing Weight (lbs.)	* Guide Rail Fitting Weight (lbs.)
					Free Standing Models			TOS or TO Guide Rail Models					
					A	B	C	D	E	F			
150BK422	6	3Ø	30	460/575	38 7/8	21 1/4	53 5/16	46 1/4	20 1/2	52 1/2	32	1220	1090
150BK437	6	3Ø	50	460/575	42 11/16	28 1/2	61 5/8	51 7/16	24 7/16	55	32	1840	1620
200BK422H	8	3Ø	30	460/575	41 1/16	21 1/4	53 5/16	54 1/8	20 1/2	53 1/4	32	1230	1110
200BK422	8	3Ø	30	460/575	42 13/16	24 7/16	51 15/16	53 3/8	21 5/8	53 1/8	32	1230	1100
200BK437	8	3Ø	50	460/575	46 7/8	28 1/2	62 1/2	56 1/4	24 3/8	58 1/16	32	1910	1720
250BK430	10	3Ø	40	460/575	51	28 1/2	61 9/16	61 5/8	25 1/2	58 15/16	32	1970	1680
250BK437	10	3Ø	50	460/575	51	28 1/2	62 11/16	61 5/8	25 1/2	60 1/16	32	2040	1770
250BK445	10	3Ø	60	460/575	51 11/16	29 15/16	65 1/2	62 1/8	26 1/4	63 1/4	32	2060	1850
250BK622	10	3Ø	30	460/575	51 11/16	29 15/16	63 11/16	62 7/16	26 5/16	61 1/4	32	1920	1760
300BK445	12	3Ø	60	460/575	53 1/16	28 1/2	67 7/16	65 5/8	26	66 11/16	32	2250	1970
300BK622	12	3Ø	30	460/575	53 3/4	29 15/16	64	66 5/16	27 3/8	64 1/8	32	2040	1810
300BK630	12	3Ø	40	460/575	53 3/4	29 15/16	65 1/8	66 5/16	27 3/8	65 1/4	32	2130	1900
300BK637	12	3Ø	50	460/575	53 3/4	29 15/16	67 9/16	66 5/16	27 3/8	67 11/16	32	2230	1950
350BK630	14	3Ø	40	460/575	58 9/16	31 1/16	66 11/16	72 5/8	28 3/4	67 5/16	32	2360	2030
350BK637	14	3Ø	50	460/575	58 9/16	31 1/16	69 1/8	72 5/8	28 3/4	69 3/4	32	2480	2140
350BK822	14	3Ø	30	460/575	58 9/16	31 1/16	67 7/16	72 5/8	28 3/4	68 1/16	32	2440	2080
400BK637	16	3Ø	50	460/575	62 5/16	31 1/16	69 1/8	83 9/16	28 3/4	72 1/16	32	2520	2450
400BK822	16	3Ø	30	460/575	62 5/16	31 1/16	67 7/16	83 9/16	28 3/4	70 3/8	32	2480	2410

* Pump Weight Only

Dimension: Free Standing

Dimension: Guide Rail Fitting (TO / TOS)

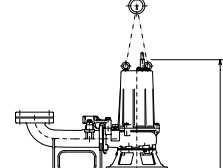
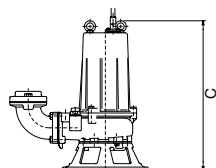
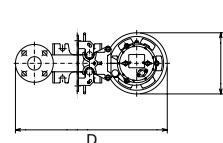
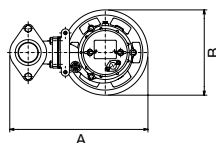

BZ Series



The **BZ SERIES** pumps utilize a unique channel impeller design to efficiently handle and transfer raw sewage. Ideal use for residential, commercial, industrial sewage, effluent, wastewater and site drainage. Available up to 15HP in Free-standing & Guide Rail designs.

Performance Curves

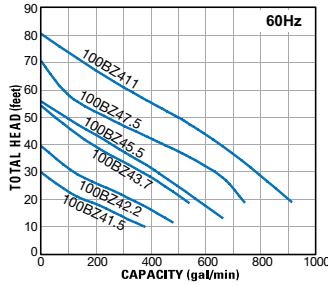

Dimension: Free Standing

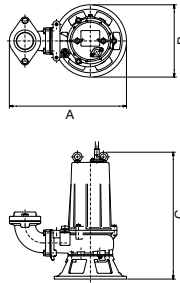

Dimension: Guide Rail Fitting (TO / TOS)

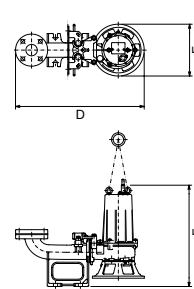

Specifications

Model	Discharge Size (inch)	Phase	Motor Output (HP)	Voltages (V)	Dimensions (inch)						Cable Length (ft)	Free Standing Weight (lbs.)	*Guide Rail Fitting Weight (lbs.)
					Free Standing Models			TOS Guide Rail Models					
					A	B	C	D	E	F			
100BZ41.5	4	3Ø	2	220/440/575	21 11/16	10 3/4	24 13/16	27 15/16	10 3/4	25 7/16	32	176	163
100BZ42.2	4	3Ø	3	220/440/575	21 11/16	10 3/4	24 13/16	27 15/16	10 3/4	25 7/16	32	176	163
100BZ43.7	4	3Ø	5	220/440/575	23	11 3/8	26 13/16	29 1/4	11 3/8	27 3/8	32	220	207
100BZ45.5	4	3Ø	7 1/2	220/440/575	28 3/16	16 9/16	36 7/16	36 13/16	16	36	32	386	370
100BZ47.5	4	3Ø	10	220/440/575	28 3/16	16 9/16	37 1/4	36 13/16	16	36 13/16	32	428	412
100BZ411	4	3Ø	15	220/440/575	28 5/8	16 15/16	40 1/4	37 1/4	16 7/8	40	32	483	467

* Pump Weight Only

MG Series



The **MG SERIES GRINDER** Tsurumi submersible pumps are designed for handling raw sewage, heavy duty industrial and food processing applications, where the pump is required to operate continuously while grinding oversize materials. With the unique high chrome grinder impeller and shredder plate design in the **MG SERIES GRINDER** pumps, Tsurumi has the right model to handle every application to efficiently transfer the most aggressive solid laden liquids, in the pump market. Available in 2, 3 & 5HP in Free-standing & Guide rail designs.

Performance Curves

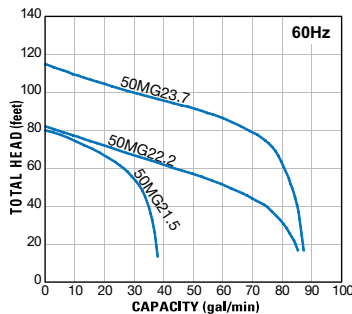

Dimension: Free Standing

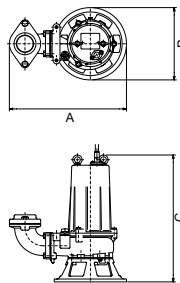

Dimension: Guide Rail Fitting (TO / TOS)

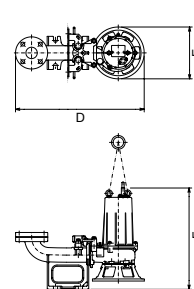

MG Series Grinder



Specifications

Model	Discharge Size (inch)	Phase	Motor Output (HP)	Voltages (V)	Dimensions (inch)						Cable Length (ft)	Free Standing Weight (lbs.)	*Guide Rail Fitting Weight (lbs.)
					Free Standing Models			TOS Guide Rail Models					
					A	B	C	D	E	F			
50MG21.5	2	3Ø	2	208-230/460/575	14 3/16	8 9/16	21 15/16	19	8 9/16	22 1/8	32	79	79
50MG22.2	2	3Ø	3	208-230/460/575	17 1/4	8 7/8	23 3/8	24 7/16	8 7/8	24 11/16	32	170	161
50MG23.7	2	3Ø	5	208-230/460/575	17 1/4	8 7/8	23 3/8	24 7/16	8 7/8	24 11/16	32	172	163

* Pump Weight Only

UZ Series



With the full Vortex impeller design, the **UZ SERIES** pumps handle a particle passage of 3", which is the smallest diameter that any of the models in this family of pumps will pass. So if passing a 3" solid is what you require, specify a Tsurumi **UZ SERIES** pump: We have the exact model to handle every application to efficiently and reliably transfer raw sewage. Available up to 15HP in Free-standing, Guide Rail designs & Dry Pit designs.

Performance Curves

Discharge Size: 2" - 3"

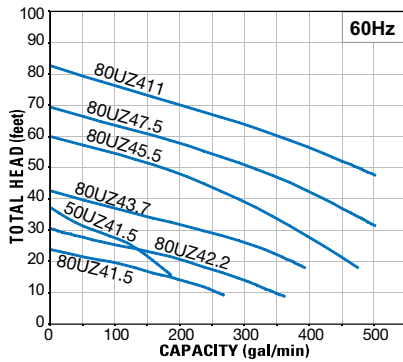

Discharge Size: 4"

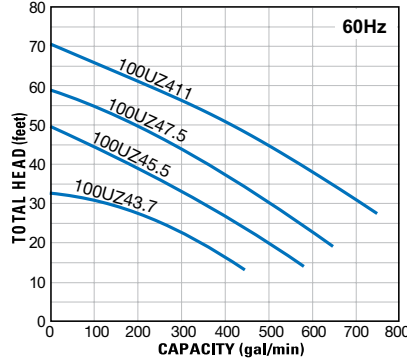

Specifications

Model	Discharge Size (inch)	Phase	Motor Output (HP)	Voltages (V)	Dimensions (inch)						Cable Length (ft)	Free Standing Weight (lbs.)	* Guide Rail Fitting Weight (lbs.)
					Free Standing Models			TOS Guide Rail Models					
					A	B	C	D	E	F			
50UZ41.5	2	3Ø	2	220/440/575	15 15/16	9 13/16	22 1/4	24 7/16	9 13/16	24 5/8	32	115	110
80UZ41.5	3	3Ø	2	220/440/575	20 7/8	10 1/4	25 1/16	27 3/4	10 1/4	26 3/8	32	146	123
80UZ42.2	3	3Ø	3	220/440/575	20 7/8	10 1/4	25 1/16	27 3/4	10 1/4	26 3/8	32	146	126
80UZ43.7	3	3Ø	5	220/440/575	21 15/16	11 7/16	27 1/16	33 5/16	12 3/8	30 9/16	32	159	154
80UZ45.5	3	3Ø	7.5	208-230/460/575	23 7/16	14 1/8	35 3/8	30 1/4	14 1/8	36 1/2	32	288	273
80UZ47.5	3	3Ø	10	208-230/460/575	23 7/16	14 1/8	36 1/4	30 1/4	14 1/8	37 5/16	32	313	294
80UZ411	3	3Ø	15	208-230/460/575	23 11/16	14 1/8	38 5/8	30 9/16	14 1/8	39 5/8	32	378	374
100UZ43.7	4	3Ø	5	220/440/575	24 11/16	12 3/8	29	28 3/4	11 7/16	28 3/8	32	174	139
100UZ45.5	4	3Ø	7.5	208-230/460/575	25 11/16	14 1/8	36 15/16	34 5/16	14 1/8	38 3/8	32	323	299
100UZ47.5	4	3Ø	10	208-230/460/575	25 11/16	14 1/8	37 13/16	34 5/16	14 1/8	39 3/16	32	351	326
100UZ411	4	3Ø	15	208-230/460/575	26	14 1/8	40 3/16	34 5/8	14 1/8	41 1/2	32	417	392

* Pump Weight Only

Dimension: Free Standing

Dimension: Guide Rail Fitting (TO / TOS)

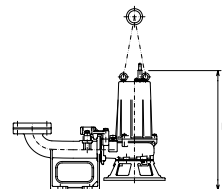
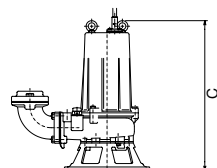
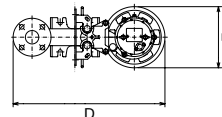
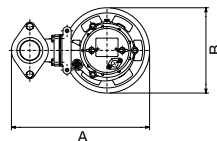

U Series



The **U SERIES** Tsurumi submersible pump is designed for handling wastewater, industrial and commercial sump pump applications. The **U Series** pump is equipped with a semi-vortex impeller designed for use in effluent and dirty water applications. Available up to 15HP in Free-standing, Guide Rail designs & Dry Pit designs.

Performance Curves

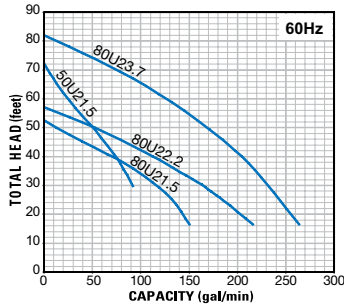

Dimension: Free Standing

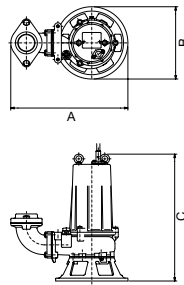

Dimension: Guide Rail Fitting (TO / TOS)

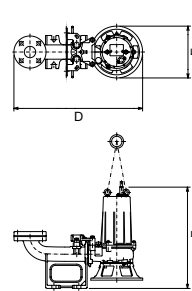

Specifications

Model	Discharge Size (inch)	Phase	Motor Output (HP)	Voltages (V)	Dimensions (inch)						Cable Length (ft)	Free Standing Weight (lbs.)	* Guide Rail Fitting Weight (lbs.)
					Free Standing Models			TOS Guide Rail Models					
					A	B	C	D	E	F			
50U21.5	2	3Ø	2	208-230/460/575	11 11/16	7 7/8	18 3/8	25 7/8	7 7/8	18 13/16	32	66	77
80U21.5	3	3Ø	2	208-230/460/575	16 9/16	7 7/8	19 3/4	24 1/8	7 7/8	23 3/4	32	88	79
80U22.2	3	3Ø	3	208-230/460/575	19 3/4	9 7/16	22 1/8	25 1/4	9 7/16	25 1/2	32	121	112
80U23.7	3	3Ø	5	208-230/460/575	19 3/4	9 3/16	22 1/4	25 1/4	9 3/16	25 9/16	32	129	127

* Pump Weight Only

VORTEX-IMPELLER SUBMERSIBLE SEWAGE PUMPS

UEF Series / UT(Z) Series



The **UEF SERIES** pump is ideal for tank transfer at small scale treatment facilities. It features a vortex impeller, making it ideal for pumping liquids containing fibrous foreign matter.

The **UT/UTZ SERIES** is an economical version of the U Series, semi-vortex submersible pumps. It is designed for a wide range of applications. Available in **automatic operation** (50UTZ2.4S/2.75S), which are equipped with floats.

Performance Curves

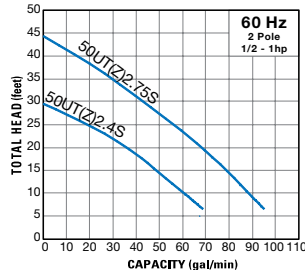
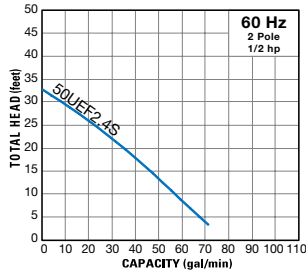

Dimension: 50UEF2.4S

Dimension: 50UT2.4S/2.75S

Dimension: 50UTZ2.4S/2.75S

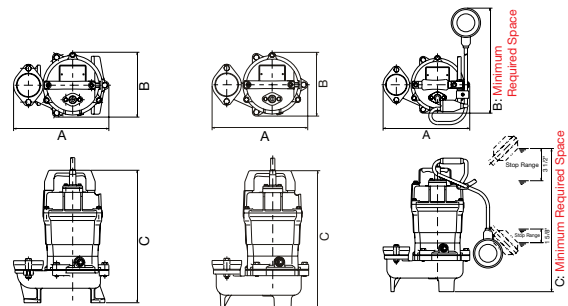

Specifications

(Suffix Z: Automatic Operation)

Model	Discharge Size (inch)	Phase	Motor Output (HP)	Voltages (V)	Solids Passage (inch)	Impeller Material	Dimensions (inch)			Cable length (ft)	Pump Weight (lbs.)
							A	B	C		
50UT2.4S	2	1Ø	1/2	110-120/220	1.4	PPO Resin	9 1/2	6 3/8	13 3/4	20	31
50UTZ2.4S	2	1Ø	1/2	110-120/220	1.4	PPO Resin	9 1/2	11 5/8 ^{*1}	15 3/4 ^{*1}	20	31
50UT2.75S	2	1Ø	1	110-120/220	1.4	PPO Resin	9 1/2	6 3/8	16	20 ^{*2}	37
50UTZ2.75S	2	1Ø	1	110-120/220	1.4	PPO Resin	9 1/2	11 5/8 ^{*1}	18 ^{*1}	20 ^{*2}	37
50UEF2.4S	2	1Ø	1/2	110-120/220	0.8	Urethane Rubber	9 5/16	6 3/8	13	20	33

^{*1} Minimum Required Space ^{*2} 32ft is optional

C Series



The **C SERIES CUTTER** pumps offer long life in both continuous and intermittent sump applications, such as; hotels, prisons, commercial, restaurants & retail applications where down time is unacceptable. With the unique cutter impeller/wear plate design in the **C SERIES CUTTER** pumps, Tsurumi has the right model to handle every application to efficiently transfer the most aggressive liquids. Available up to 30HP in Free-standing, Guide Rail & Dry Pit designs.

Performance Curves

Discharge Size: 2" - 3"

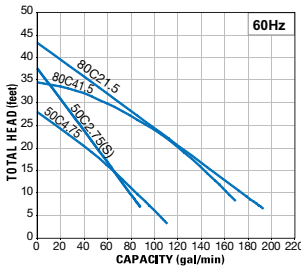

Discharge Size: 4"

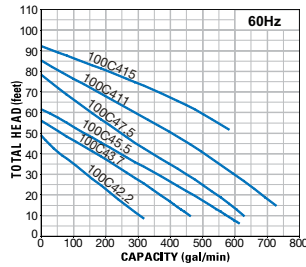

Discharge Size: 6" - 8"

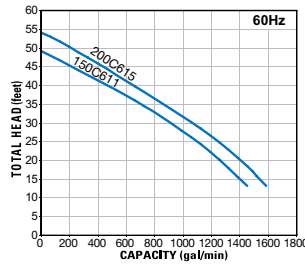

High Head Models

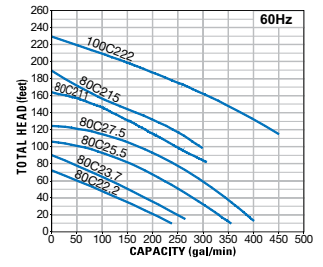

Specifications

Model	Discharge Size (inch)	Phase	Motor Output (HP)	Voltages (V)	Dimensions (inch)						Cable Length (ft)	Free Standing Weight (lbs.)	* Guide Rail Fitting Weight (lbs.)
					Free Standing Models			TOS or TO Guide Rail Models					
					A	B	C	D	E	F			
50C2.75S	2	1Ø	1	115-120/230	15 15/16	9 13/16	20 9/16	24 7/16	9 13/16	22 5/16	32	70	66
50C2.75	2	3Ø	1	208-230/460/575	15 15/16	9 13/16	16 5/16	24 7/16	9 13/16	18 1/16	32	53	51
50C4.75	2	3Ø	1	208-230/460/575	16 13/16	11 3/16	19 5/8	25 5/16	11 3/16	21 9/16	32	104	90
80C21.5	3	3Ø	2	208-230/460/575	17 9/16	9 13/16	21 1/8	26 5/16	9 13/16	23 1/16	32	79	75
80C41.5	3	3Ø	2	208-230/460/575	19 5/8	12 7/16	23	28 3/8	12 7/16	23 7/8	32	119	115
100C42.2	4	3Ø	3	208-230/460/575	23 3/8	12 3/4	24 1/4	29 11/16	12 3/4	24 13/16	32	154	141
100C43.7	4	3Ø	5	208-230/460/575	23 9/16	13 1/8	27 3/16	29 7/8	13 1/8	27 9/16	32	183	170
100C45.5	4	3Ø	7 1/2	208-230/460/575	27	16 1/8	35 3/4	35 5/8	15 1/8	35 11/16	32	309	293
100C47.5	4	3Ø	10	208-230/460/575	27	16 1/8	36 9/16	35 5/8	15 1/8	36 1/2	32	349	334
100C41.1	4	3Ø	15	208-230/460/575	27 15/16	17 3/16	39 3/8	36 9/16	16 15/16	39 5/16	32	406	390
100C415	4	3Ø	20	208-230/460/575	27 13/16	17 3/16	42 1/2	36 7/16	16 11/16	42 7/16	32	705	690
150C61.1	6	3Ø	15	208-230/460/575	41 1/16	23 11/16	47 11/16	48 3/8	22	46 5/16	32	950	880
200C61.5	8	3Ø	20	208-230/460/575	43 1/4	23 11/16	49 5/8	56 1/4	22	49 1/16	32	1210	1150

* Pump Weight Only

C Series High Head

Model	Discharge Size (inch)	Phase	Motor Output (HP)	Voltages (V)	Dimensions (inch)						Cable Length (ft)	Free Standing Weight (lbs.)	* Guide Rail Fitting Weight (lbs.)
					Free Standing Models			TOS Guide Rail Models					
					A	B	C	D	E	F			
80C22.2	3	3Ø	3	208-230/460/575	20 7/16	10 1/4	24 1/16	27 5/16	10 1/4	25 3/16	32	139	130
80C23.7	3	3Ø	5	208-230/460/575	20 7/16	10 1/4	24 1/16	27 5/16	10 1/4	25 3/16	32	141	132
80C25.5	3	3Ø	7 1/2	208-230/460/575	24 3/16	13 9/16	34 5/8	31	12 5/8	35 1/2	32	278	265
80C27.5	3	3Ø	10	208-230/460/575	24 3/16	13 9/16	34 5/8	31	12 5/8	35 1/2	32	284	271
80C211	3	3Ø	15	208-230/460/575	24 3/16	13 9/16	36 1/2	31	12 5/8	36 7/16	32	326	313
80C215	3	3Ø	20	208-230/460/575	28 3/4	16 15/16	42 11/16	37 3/16	16 15/16	42 3/4	32	880	820
100C222	3	3Ø	30	460/575	32 15/16	20 1/16	46 5/8	40 3/8	20 1/16	46 5/8	32	930	840

* Pump Weight Only

Dimension: Free Standing

Dimension: Guide Rail Fitting (TO / TOS)

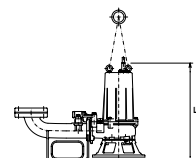
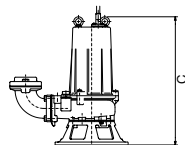
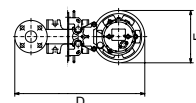
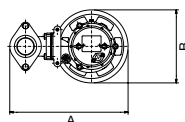

SFQ Series

TSURUMI SFQ Series Stainless Steel Pumps are solidly engineered pumps to endure the corrosive environment of your toughest applications.



- All wetted metal components are SS 316 Stainless Steel.
- Viton elastomers
- Dual inside mechanical seals with Silicon Carbide faces, running in an oil filled chamber and further protected by an exclusionary lip seal, providing the most durable seal available.
- Optional 316 SS Slide rail system is available for models from 7 1/2 - 15hp.
- Seal pressure relief system features an independent chamber separate from the oil casing in which the mechanical seal is housed.

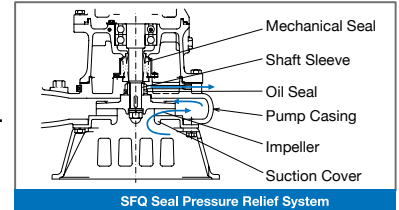

Performance Curves

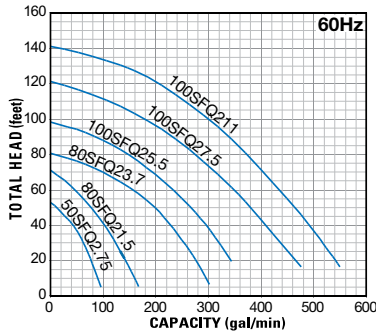

Specifications

Model	Discharge Size (inch)	Phase	Motor Output (HP)	Voltages	Dimensions (inch)						Cable length (ft)	Free Standing Weight (lbs.)	* Guide Rail Fitting (lbs.)
					Free Standing Models			TO Guide Rail Models					
					A	B	C	D	E	F			
50SFQ2.75	2	3Ø	1	440	9 15/16	7 11/16	15 5/8	N/A	N/A	N/A	32	49	N/A
80SFQ21.5	3	3Ø	2	440	12 15/16	8 11/16	19 1/16	N/A	N/A	N/A	32	79	N/A
80SFQ23.7	3	3Ø	5	440	14 1/8	10 1/8	21 5/16	N/A	N/A	N/A	32	115	N/A
100SFQ25.5	4	3Ø	7.5	440	25	14 3/16	33 1/4	31 13/16	14 3/16	21 5/8	32	273	249
100SFQ27.5	4	3Ø	10	440	25	14 3/16	33 1/4	31 13/16	14 3/16	21 5/8	32	271	247
100SFQ211	4	3Ø	15	440	25	14 3/16	35 1/8	31 13/16	14 3/16	21 5/8	32	315	291

* Pump weight only

Dimension: Free Standing

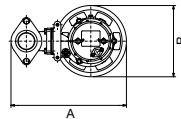

Dimension: Guide Rail Fitting (TO / TOS)

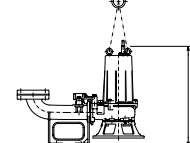
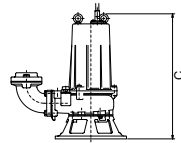
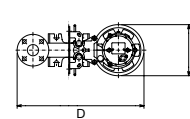

COMPACT & LIGHTWEIGHT STAINLESS STEEL PUMPS

SQ Series

TSURUMI SQ Series Stainless Steel Pumps are rust-free and corrosive resistant.



- All components including motor frame are made of SS 304 Stainless Steel.
- White mineral oil is used as the lubricant.
- The flow-through design and heat resistant Silicon Carbide Mechanical Seals assist in cooling in the event of run-dry situations.
- Semi-vortex, stainless steel impeller with replaceable / adjustable wear plate increases wear resistance when pumpage contains abrasive particles.

Performance Curves

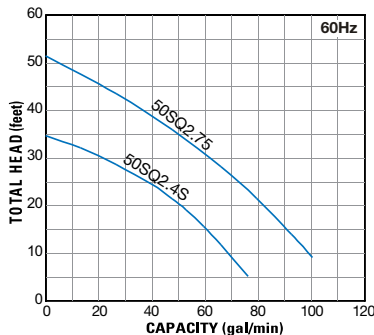

Specifications

Model	Discharge Size (inch)	Phase	Motor Output (HP)	Voltages	Dimensions (inch)						Cable length (ft)	Free Standing Weight (lbs.)	* Guide Rail Fitting (lbs.)
					Free Standing Models			TOS Guide Rail Models					
					A	B	C	D	E	F			
50SQ2.4S	2	1Ø	1/2	115	7 1/16	7 1/16	14 5/16	N/A	N/A	N/A	32	29	N/A
50SQ2.75	2	3Ø	1	220/440	7 1/16	7 1/16	14 5/16	N/A	N/A	N/A	32	31	N/A

* Pump weight only

Dimension: Free Standing

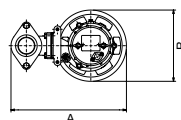

Dimension: Guide Rail Fitting (TO / TOS)

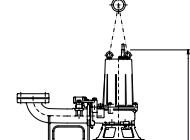
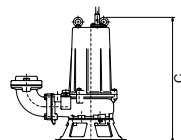
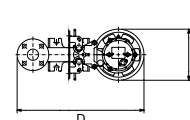

VANCS Series



The **VANCS SERIES** Tsurumi submersible pump is designed for handling raw sewage, wastewater, industrial and commercial sump pump applications. The **VANCS SERIES** has a proven track record for offering long life in both continuous and intermittent sump applications. With the pump made of complete molded resin material and all other parts coming in contact with the pump liquid in either 304 SS or Titanium.

Applications

- Residential, commercial, industrial, effluent, wastewater and site drainage.
- Chemical spill containment
- Raw water supply from rivers or lakes.
- **For TM Series: Titanium components increases corrosion resistance in a wide variety of applications. Ideal use for salt wastewater, site drainage and bilge pumps**
- **Automatic Operation and Auto Alternating Operation are available**

Model Name Description

Description: PN, PU, PSF and TM Series

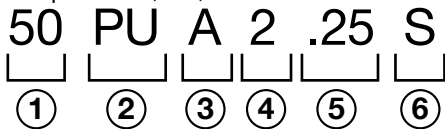

- ① Discharge Size (mm)
- ② Model Name
- ③ Operation
None: Manual, A: Automatic with Floats
W: Auto Alternating, F: Automatic with Vertical Float
- ④ Number of Poles in Motor
- ⑤ Motor Output (kW)
- ⑥ Phase
S: Single Phase, None: Three Phase

Description: OM Series

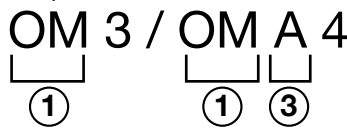

AUTO DUPLEXING - MADE SIMPLE

VANCS Series pumps are available with automatic duplexing capabilities eliminating the need for a duplexing control panel*. The auto-alternating model has three floats and can be identified by the suffix "W". Refer to standard specifications for availability and model numbers. It is available in the same output range of the automatic pumps.

*Note: Must be installed in accordance with all National or Local Electrical or Building Codes.

Dimension Description

Dimension:
Free Standing
(PU, PN, PSF, TM, OM Series)

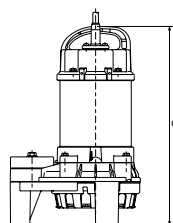
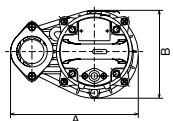

Dimension:
Free Standing
(PUF2.15S, OMA4)

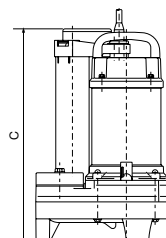
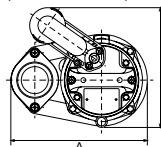

Dimension:
Guide Rail Fitting TOK
(PU, PN, PSF, TM Series)

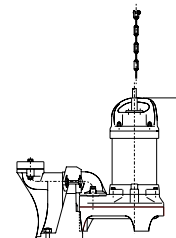
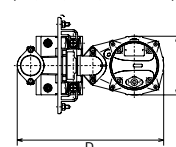

Performance Curves

Semi-Vortex Impeller PU Series

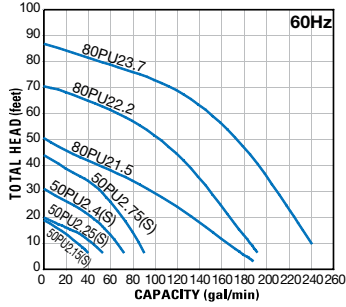

Semi-Open Impeller PN Series

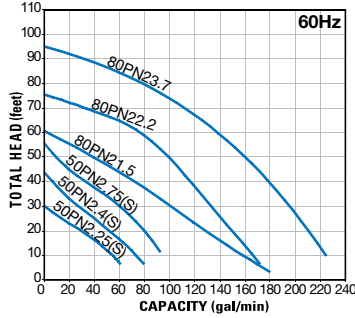

Semi-Vortex Impeller OM Series

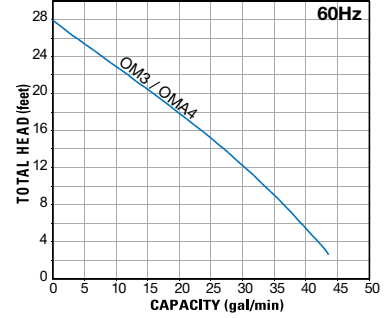

Enclosed Impeller PSF Series

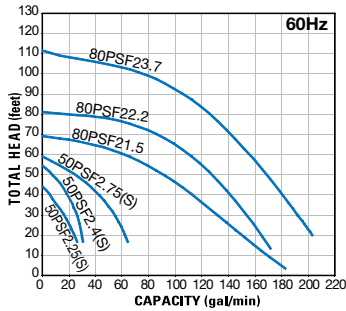

Corrosion Resistant Titanium TM Series

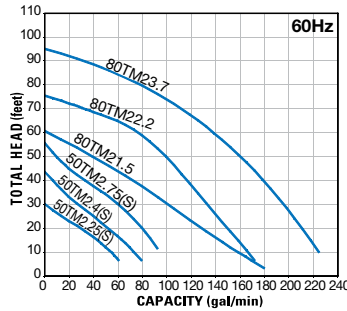

Specifications

	Model	Discharge Size (inch)	Phase	Motor Output (HP)	Voltages (V)	Dimensions (inch)						Cable Length (ft)	Free Standing Weight (lbs.)	* Guide Rail Fitting Weight (lbs.)
						Free Standing Models			TOK Guide Rail Models					
						A	B	C	D	E	F			
PU Series	50PU2.15S	2	1Ø	1/5	115/230	8 7/8	6 1/16	14 13/16	16	6 1/16	16 1/8	20	13.4	14.3
	50PU2.15S	2	1Ø	1/5	115/230	8 7/8	7 3/4	14	N/A	N/A	N/A	20	14.6	N/A
	50PU2.25S	2	1Ø	1/3	115/230	9 5/16	6 3/8	14 3/16	16 3/4	6 11/16	16	32	15.6	16.5
	50PU2.25	2	3Ø	1/3	230/460	9 5/16	6 3/8	13 3/4	16 3/4	6 11/16	16	32	13.4	15.6
	50PU2.4S	2	1Ø	1/2	115/230	9 5/16	6 3/8	14 3/16	16 3/4	6 11/16	16 5/16	32	15.6	16.5
	50PU2.4	2	3Ø	1/2	230/460	9 5/16	6 3/8	14 3/16	16 3/4	6 11/16	16 5/16	32	15.4	16.3
	50PU2.75S	2	1Ø	1	115/230	9 5/16	6 3/8	14 15/16	16 3/4	6 11/16	16 7/8	32	19.6	20.5
	50PU2.75	2	3Ø	1	230/460	9 5/16	6 3/8	14 3/4	16 3/4	6 11/16	16 7/8	32	18.3	21.1
	80PU21.5	3	3Ø	2	208-220/440	11 5/8	7 11/16	18 11/16	20 11/16	7 11/16	19 5/16	32	35.3	36.4
	80PU2.2	3	3Ø	3	208-220/460/575	12 1/4	8 3/8	22 15/16	21 5/16	8 3/8	23 3/8	32	48.5	49.6
80PU23.7	3	3Ø	5	208-220/460/575	12 1/4	8 3/8	24 5/16	21 5/16	8 3/8	24 3/4	32	59.5	60.6	
PN Series	50PN2.25S	2	1Ø	1/3	115/230	9 5/16	6 3/8	14 3/16	16 3/4	6 11/16	16	32	15.6	16.5
	50PN2.25	2	3Ø	1/3	230/460	9 5/16	6 3/8	13 3/4	16 3/4	6 11/16	16	32	13.4	15.6
	50PN2.4S	2	1Ø	1/2	115/230	9 5/16	6 3/8	14 3/16	16 3/4	6 11/16	16 5/16	32	15.6	16.5
	50PN2.4	2	3Ø	1/2	230/460	9 5/16	6 3/8	14 3/16	16 3/4	6 11/16	16 5/16	32	15.4	16.3
	50PN2.75S	2	1Ø	1	115/230	9 5/16	6 3/8	14 15/16	16 3/4	6 11/16	16 7/8	32	19.6	20.5
	50PN2.75	2	3Ø	1	230/460	9 5/16	6 3/8	14 3/4	16 3/4	6 11/16	16 7/8	32	18.3	19.2
	80PN21.5	3	3Ø	2	208-220/440	11 5/8	7 11/16	17 1/8	20 11/16	7 11/16	19 5/16	32	35.1	36.2
	80PN22.2	3	3Ø	3	208-220/460/575	12 1/4	8 3/8	22	21 5/16	8 3/8	23 3/8	32	48.5	49.6
	80PN23.7	3	3Ø	5	208-220/460/575	12 1/4	8 3/8	23 3/8	21 5/16	8 3/8	24 3/4	32	59.5	60.6
	PSF Series	50PSF2.25S	2	1Ø	1/3	115/230	9 5/16	6 3/8	14 3/16	16 3/4	6 11/16	16	32	15.9
50PSF2.25		2	3Ø	1/3	230/460	9 5/16	6 3/8	13 3/4	16 3/4	6 11/16	16	32	13.7	14.6
50PSF2.4S		2	1Ø	1/2	115/230	9 5/16	6 3/8	14 3/16	16 3/4	6 11/16	16 5/16	32	15.9	18.9
50PSF2.4		2	3Ø	1/2	230/460	9 5/16	6 3/8	14 3/16	16 3/4	6 11/16	16 5/16	32	15.6	17.8
50PSF2.75S		2	1Ø	1	115/230	9 5/16	6 3/8	14 15/16	16 3/4	6 11/16	16 7/8	32	19.8	20.7
50PSF2.75		2	3Ø	1	230/460	9 5/16	6 3/8	14 3/4	16 3/4	6 11/16	16 7/8	32	18.5	19.4
80PSF21.5		3	3Ø	2	208-220/440	11 5/8	7 11/16	17 1/8	20 11/16	7 11/16	19 5/16	32	35.3	36.4
80PSF22.2		3	3Ø	3	208-220/460/575	12 1/4	8 3/8	22	21 5/16	8 3/8	23 3/8	32	48.5	49.6
80PSF23.7		3	3Ø	5	208-220/460/575	12 1/4	8 3/8	23 3/8	21 5/16	8 3/8	24 3/4	32	59.5	60.6
TM Series		50TM2.4S	2	1Ø	1/2	115/230	9 5/16	6 3/8	14 3/16	N/A	N/A	N/A	32	14.8
	50TM2.4	2	3Ø	1/2	230/460	9 5/16	6 3/8	14 3/16	N/A	N/A	N/A	32	14.5	N/A
	50TM2.75S	2	1Ø	1	230/460	9 5/16	6 3/8	14 3/4	N/A	N/A	N/A	32	18.0	N/A
	50TM2.75	2	3Ø	1	230/460	9 5/16	6 3/8	14 3/4	N/A	N/A	N/A	32	17.4	N/A
	80TM21.5	3	3Ø	2	208-220/440	11 5/8	7 11/16	17 1/8	N/A	N/A	N/A	32	32.8	N/A
	80TM22.2	3	3Ø	3	208-220/460/575	12 1/4	8 3/8	22	N/A	N/A	N/A	32	46.3	N/A
	80TM23.7	3	3Ø	5	208-220/460/575	12 1/4	8 3/8	23 3/8	N/A	N/A	N/A	32	57.3	N/A
	OM	OM3	1.5	1Ø	1/5	115-120/230	8	5 1/2	12 7/16	N/A	N/A	N/A	20	13.0
OMA4		1.5	1Ø	1/5	115-120/230	8	6 15/16	12 11/16	N/A	N/A	N/A	20	13.5	N/A

* Pump Weight Only



CONTROL PANELS & MOISTURE DETECTOR

■ TS SERIES CONTROL PANELS



Features

- Lockable – 4X Enclosures
- HOA Switch – Heavy Duty Oil Tight
- Terminal Block – For Field Wiring
- Pump Run Indicator – Heavy Duty Oil Tight
- Multi-Tap Control Transformer 208/230/460VAC Operation
- Control Alarm Fuse
- Motor Protective Switch
- Adjustable Overload Protection
- IEC Rated Magnetic Contactor
- Horn Silence Switch – Heavy Duty Oil Tight
- Auto Reset Horn Silence
- Buzzer – 95db warble
- Red Alarm Beacon
- Includes three (3) Mechanical Float Switches & Pipe Clamp

■ SEAL MOISTURE PROBE



The **TSMP SEAL MOISTURE PROBE** is designed to detect moisture in the mechanical seal chamber, alerting customers of potential motor failure. The **TSMP SEAL MOISTURE PROBE** can be field installed on any new or existing Tsurumi pump models and connected to the control panel for the appropriate alarm or notification.

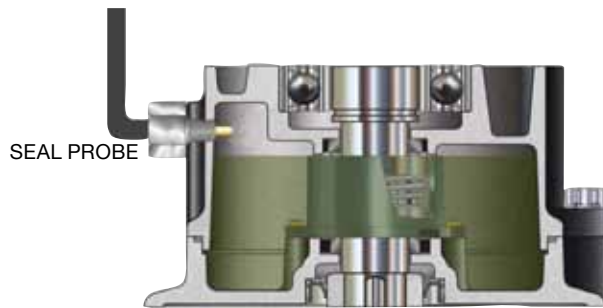

Principle of Operation:

Sensor is installed through the oil port and directly into the mechanical seal chamber which contains an electrically non-conductive oil.

The presence of water changes the chamber fluid mixture to a conductive condition and therefore completes the circuit which will result in a leakage indication on the control panel.

Electrical Specification

Sensor Type:	Conductive
Suggested Seal Fail Relay Voltage:	24 VAC
Required Wiring:	Single wire in separate sensor cable to be connected to seal leak relay in control panel by customer.



For Sales, Service, and Specifications, call:

1-888-TSURUMI (878-7864)

1-800-748-4458 (Utah Office)

TSURUMI (AMERICA), INC.

1625 Fullerton Court
 Glendale Heights, IL 60139
 Tel: 1-888-878-7864 (Toll-Free)
 1-630-793-0127
 Fax: 1-630-793-0146

TSURUMI (AMERICA), INC. WEST

6216 West 9790 South
 West Jordan, UT 84081
 Tel: 1-800-748-4458 (Toll-Free)
 1-801-563-5910
 Fax: 1-801-563-5911

Your Dealer

Visit our website: www.tsurumipump.com